

CAT5E JUNCTION BOX SPLICE BOX (SHIELDED)



DESCRIPTION

CAT5E Junction Box Shielded, T568A & T568B Standards, Splice Box, Compatible with 110 & Krone Termination Tools.

FEATURES

- High-impact ABS construction
- Screws, ties and adhesive tape included
- 110 & Krone type terminal blocks
- Can be terminated with 110 or Krone type tools
- UL 94V-0 Fire Retardant
- Fully Shielded Box
- T568A & T568B Color Codes
- UL Listed

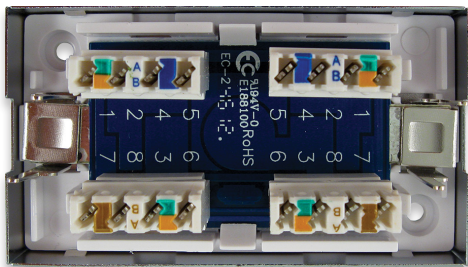

040-373/C5J/S

SPECIFICATIONS

MATERIAL

Housing: ABS, UL 94V-0
Metal Cover: SPCC, 0.5 mm thickness with Chromium plating

IDC

Housing: PC + Glass Fiber, UL 94V-2
Terminal: Phosper Bronze with Tin plating

PCB

FR4, UL 94V-0

ENVIRONMENTAL

Operating Temperature: -10°C - 60°C

PERFORMANCE

Meets or exceeds ISO/IEC 11801, ANSI/TIA-568.2-D

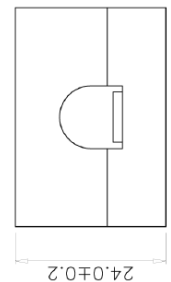
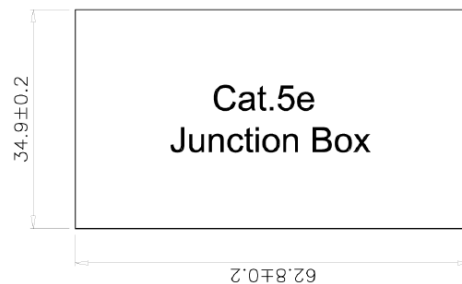
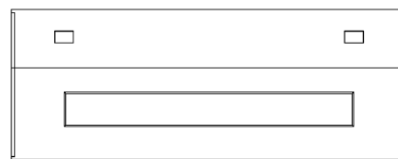
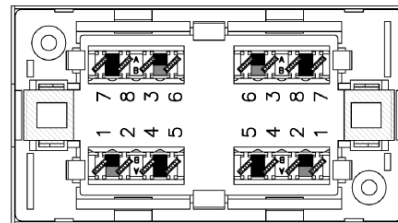

VERTICAL CABLE

951.696.7772 California
800.749.2447 Florida
845.391.8318 New York
713.322.7242 Texas



verticalcable.com

Rev. 03/2025

Subject to change without notice.